

## CPLM-970 DIRECTIONAL COUPLER

### Features:

- Lowest Loss and VSWR
- Custom Designs Available
- Surface Mounted
- Low Cost
- Available on Tape and Reel

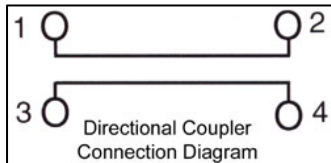

### Outline Drawing

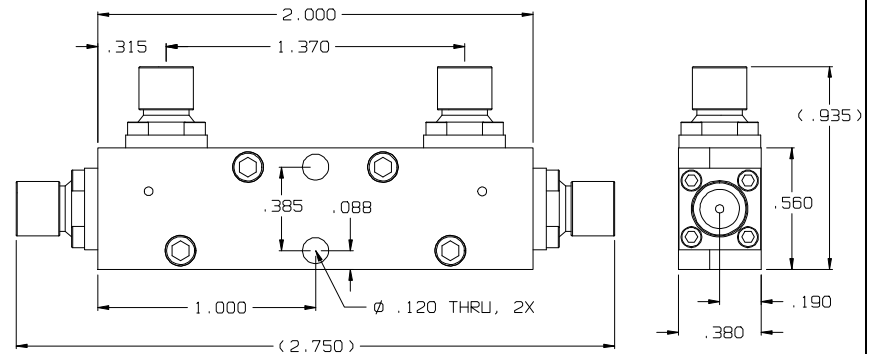

All dimensions in inches

### Electrical Specifications:

<b>Frequency Range:</b>	0.5 to 2 GHz
<b>Frequency Sensitivity:</b>	± 0.6 dB
<b>Insertion Loss:</b>	0.25 dB
<b>Coupling (nom.):</b>	10 ± 1.0 dB
<b>VSWR:</b>	1.25:1 max.
<b>Power Handling:</b>	5 Watts
<b>Directivity (typ.):</b>	18 dB min.

### Mechanical Specifications:

<b>Dimensions:</b>	2.0" x 0.560" x 0.380"
<b>Connectors:</b>	SMA(f) x4
<b>Mounting:</b>	Ø 0.120" Holes x2

### Environmental Specifications:

<b>Operating Temperature:</b>	-55°C to +90°C
-------------------------------	----------------

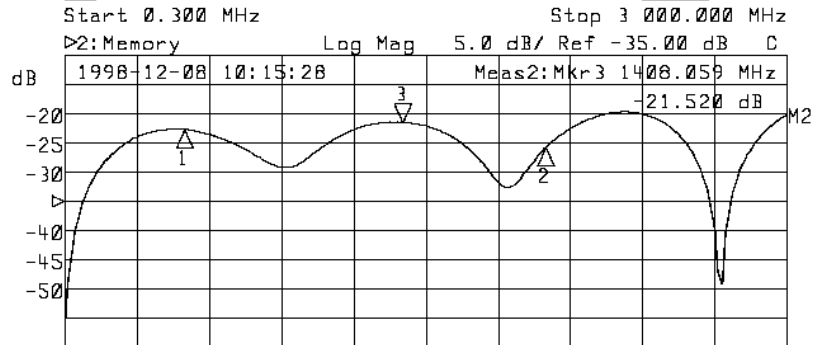
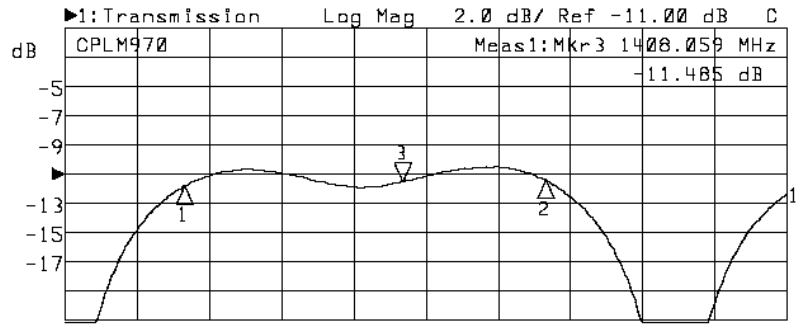

Start 0.300 MHz		Stop 3 000.000 MHz	
1: Mkr (MHz)	dB	2: Mkr (MHz)	dB
1: 500.00	-11.803	1: 500.00	-22.753
2: 2000.00	-11.421	2: 2000.00	-25.730
3> 1400.06	-11.485	3> 1400.06	-21.520